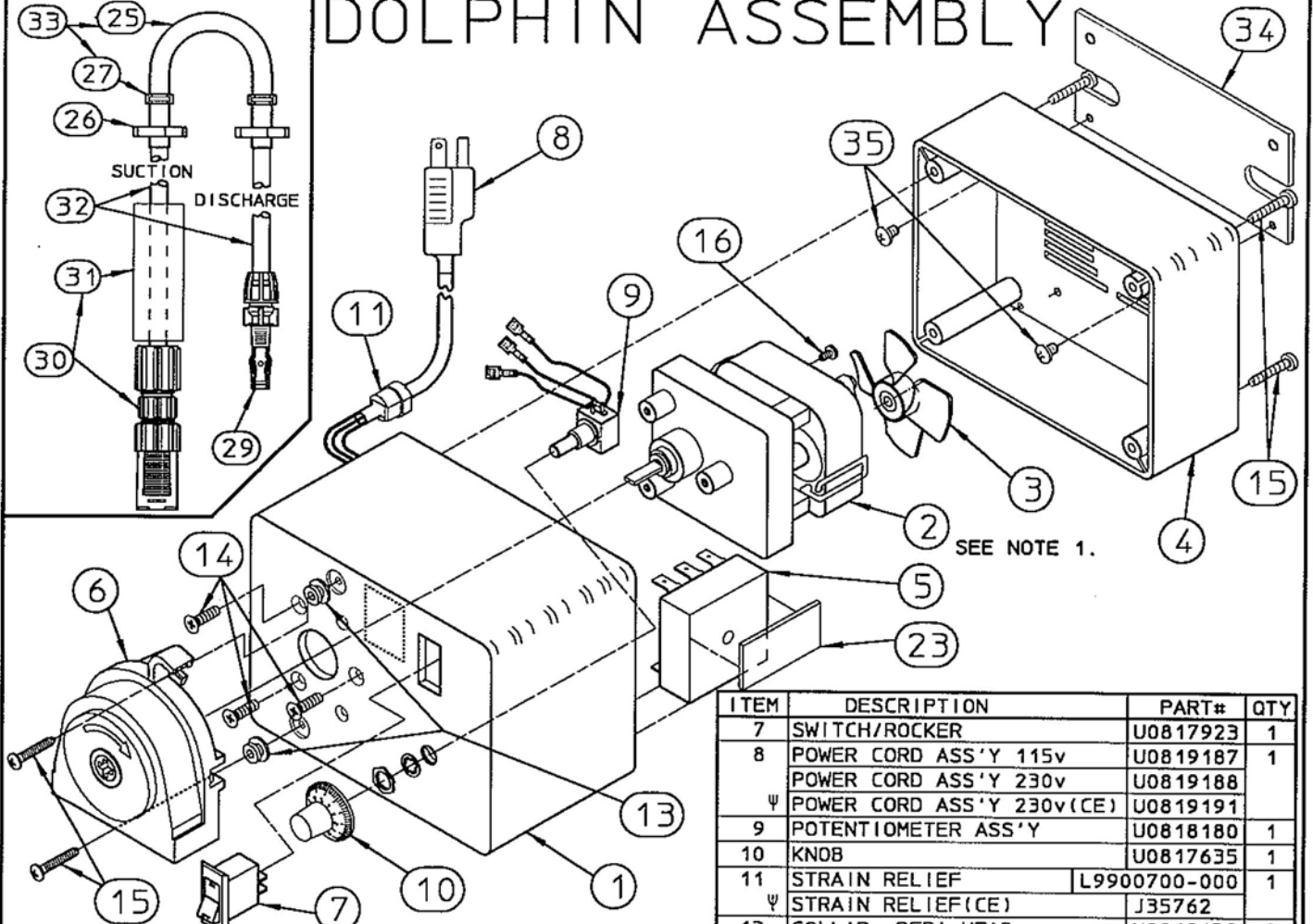

FIGURE #8

DOLPHIN ASSEMBLY



ITEM	DESCRIPTION	PART#	QTY
1	PUMP HOUSING	U0819142	1
ψ	PUMP HOUSING(CE)	U0819173	
2	KIT, MOTOR 10-rpm 115v	U0818616	1
	KIT, MOTOR 10-rpm 230v	U0818617	
	KIT, MOTOR 50-rpm 115v	U0818618	
	KIT, MOTOR 50-rpm 230v	U0818619	
	KIT, MOTOR 75-rpm 115v	U0818620	
	KIT, MOTOR 75-rpm 230v	U0818621	
3	FAN, DOLPHIN-10 only	U0818564	1
	FAN, DOLPHIN-50/75	U0818565	
4	PUMP COVER	U0819143	1
ψ	PUMP COVER(CE)	U0819146	
5	TIMER 115v	U0818183	1
	TIMER 230v	U0818460	
6#	PUMP HEAD ASS'Y w/PAD	U8800651	1

ITEM	DESCRIPTION	PART#	QTY
7	SWITCH/ROCKER	U0817923	1
8	POWER CORD ASS'Y 115v	U0819187	1
	POWER CORD ASS'Y 230v	U0819188	
ψ	POWER CORD ASS'Y 230v(CE)	U0819191	
9	POTENTIOMETER ASS'Y	U0818180	1
10	KNOB	U0817635	1
11	STRAIN RELIEF	L9900700-000	1
ψ	STRAIN RELIEF(CE)	J35762	
13	COLLAR, PERI HEAD	U0819132	2
14	SCREW,#10-32 x .68'lg.	U0817942	3
15	SCREW,#8-18 x 1.0'lg	L9806200-188	6
16	SCREW,#6-32 x .25'lg.	U0812955	1
21	LEAD ASS'Y, YELLOW	U0817630	1
22	LEAD ASS'Y, BLACK	U0819189	1
23	TAPE, DBLE. SIDED	U0020522	1'
25	HEAD TUBE,PERI φ.44-NOR	U0817926	1
26	HOSE CLAMP	U0817742	2
27	TUBE COLLAR	U0817123	2
29	INJECTION FITTING	U8800712	1
30*	STRAINER ASS'Y	J60552WT	1
31	STRAINER WEIGHT	L9906700-000	REF
32	TUBING 1/4' x 20'	U8800431	1
33+	KIT, HEAD TUBE φ.44-NOR	U8800637	REF
34ψ	BRACKET, PUMP MOUNTING	U0819178	1
35ψ	SCREW, #10-32 x .25'-lg.	U0811205	2
36	LEAD ASS'Y, Y-CONN	NC970015-000	1

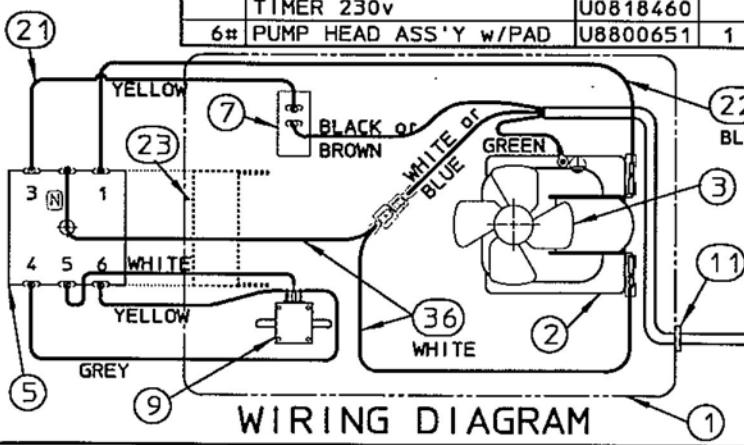

WIRING DIAGRAM

- INCLUDES ITEMS #6a thru 6d.
 + - INCLUDES TWO COLLARS (ITEM #27).
 * - INCLUDES WEIGHT (ITEM #31).
 ψ - USED ON 'CE' APPROVED PUMPS.

NOTES: 1. MOTOR KITS (ITEM #2) ALSO INCLUDE ITEMS #3, #16, #21, AND #22.
 2. ALL WIRES MUST BE PLACED and/or SECURED TO CLEAR FAN BLADES (ITEM #3).
 3.

US COLORS	WIRING	EURO COLORS
WHITE	= NEUTRAL	= BLUE
BLACK	= LINE	= BROWN
GREEN	= EARTH	= GREEN w/ YELLOW.

SEE NOTE 3. U0818236, D/8